

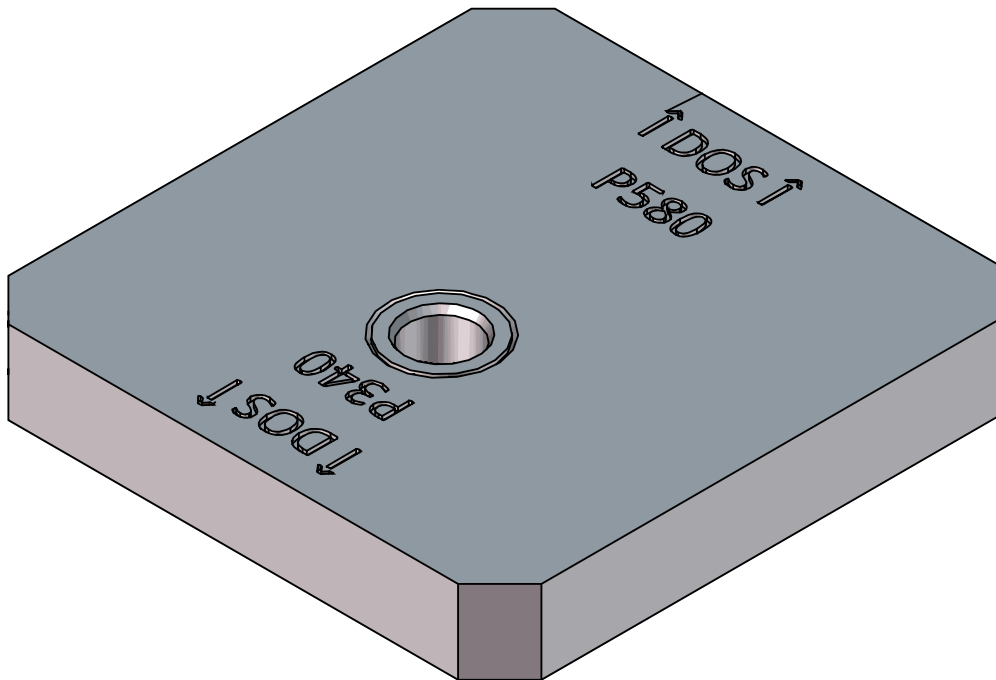



# Gabarit de perçage pour bas H83

## Drilling guide for H83 base units

Instructions de montage

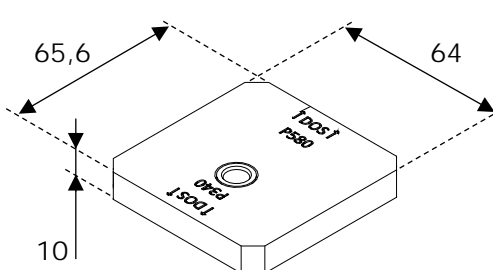
Mounting instructions

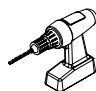
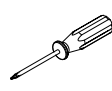

| Dimensions (mm)   |  | Références / References   |   |   |
|---|--|---|---|---|
|  |  | GPRPA   | cbc_GPRPA   |   |
|   |  | Nécessaire / Necessary  |   |   |
|  |  |  |  |  |

1 Profondeur 580 mm / 580 mm depth

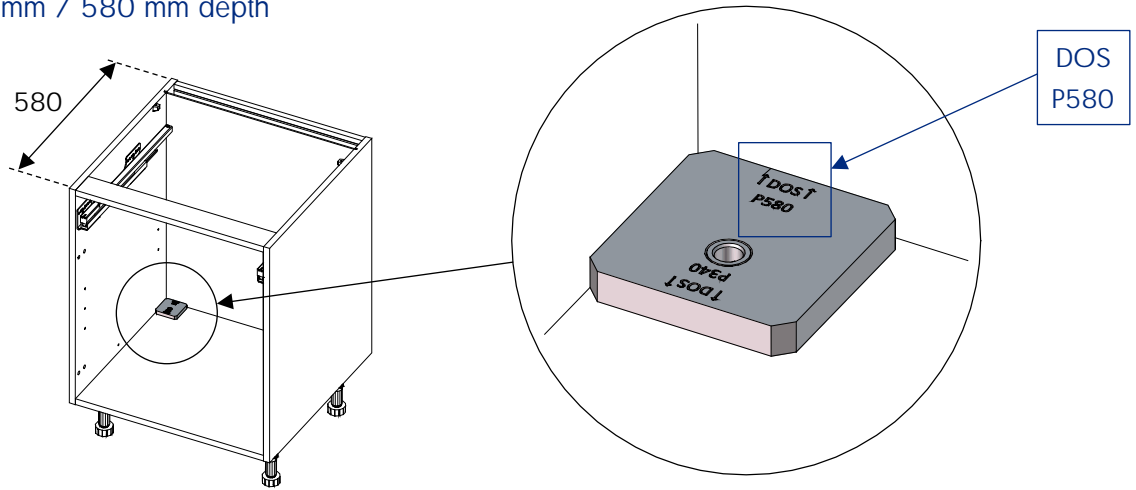

1' Profondeur 340 mm / 340 mm depth

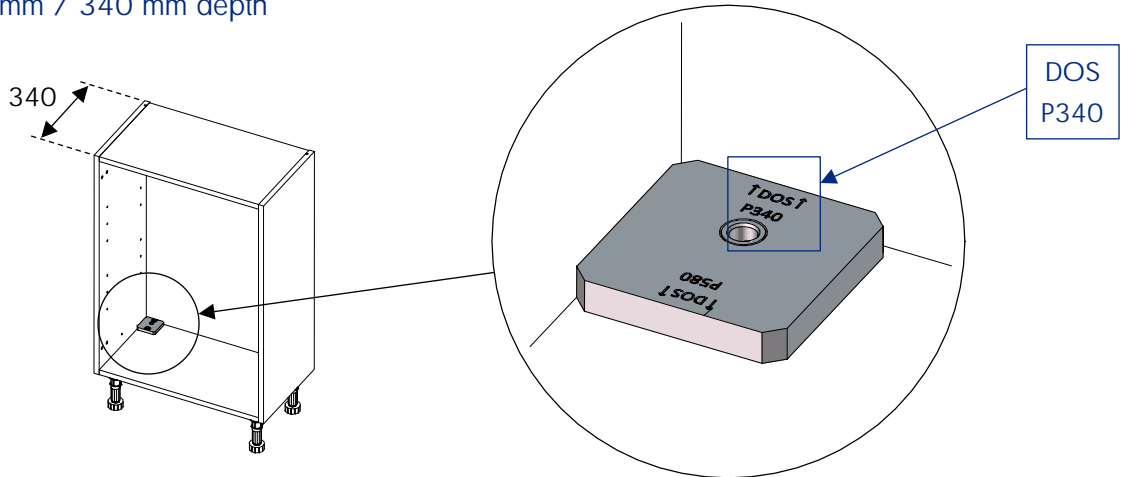

2

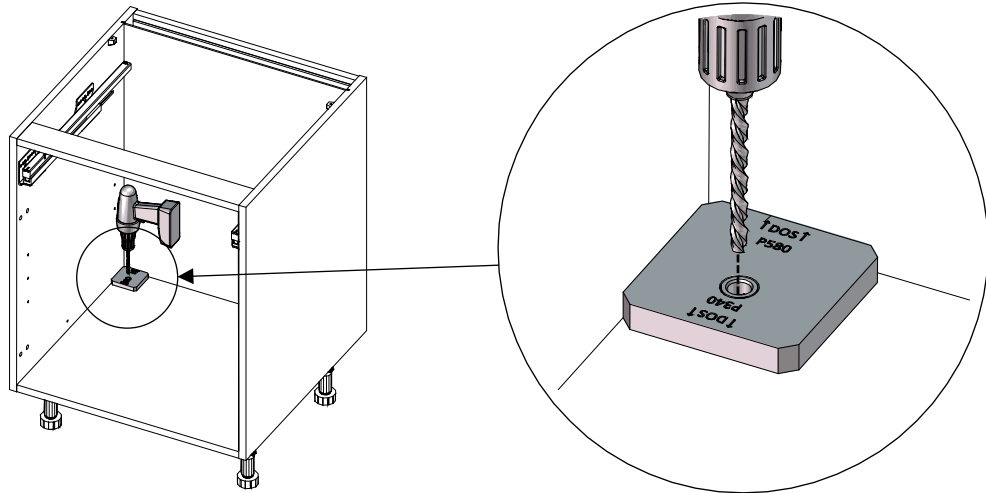

3

